





A richiesta sono disponibili le certificazioni:     
Certifications available on request:

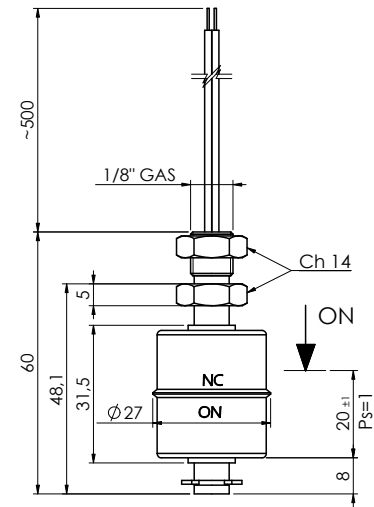
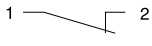

Codice Part number	
1  2	 NC BIANCO/WHITE  NO MARRONE/BROWN <small>CARANZIONE/ ORANGE</small>
IMPO60 - 100	IMPO60 - 500
Per passare da N.C. a N.A. è sufficiente capovolgere il galleggiante <i>The contact can be converted from N.C. to N.O. by rotating the float upside down</i>	Contatto SPDT SPDT Contact
Il collegamento a terra deve essere garantito dal sistema di montaggio <i>Grounding must be fasten by assembling system</i>	

Per versione UL aggiungere la lettera U alla fine del codice Esempio: IMPU  
For UL version add **U** at the end of the code Example: IMPU

Per versioni personalizzate (tipo di cablaggio, temperatura > 100°C, ecc.) contattare i nostri Uffici Commerciali.  
Nel caso di connessioni non isolate devono essere prese le adeguate precauzioni per garantire la distanza minima di sicurezza tra i diversi morsetti.

*For customized version (type of cable, temperature > 100°C, etc.) please contact our Customer Service.  
When using non-insulated connections, the necessary precautions must be taken to ensure the minimum safety distance between the terminals.*

Impiego Use	Acqua - Olio - Acidi - Carburanti (Fluidi alimentari a richiesta) Water - Oil - Acids - Fuels (Alimentary liquids on request)
Fissaggio Fixing	1/8" gas
Stelo Stem	Inox aisi 304 Stainless steel aisi 304
Galleggiante Float	Inox aisi 316 Stainless steel aisi 316
Dado Nut	Inox aisi 304 Stainless steel aisi 304
Seeger	Inox aisi 316 Stainless steel aisi 316
Connessione elettrica Electrical connection	500 mm (Altre a richiesta) (Others on request) Cablaggi categoria Wiring category UL AVLV2

Tipo contatto Type of contact	Reed N.A./N.C. (SPDT) Reed N.O./ N.C. (SPDT)	
Max potenza commut. Max switch. capacity	40 W - (3 W SPDT)	
Max corrente commut. Max switch. current	1 A - (0.25 A SPDT)	Versione UL UL Version 0.189 A (0.25 A SPDT)
Max tensione commut. Max switch. voltage	250 Vac (50V SPDT)	250 Vac (125 Vac SPDT)
Temp. in funzionamento Working temperature	-20°C / +100°C (HT -20°C / +200°C)	Surrounding temperature -20° / +90°C
Peso specif. liquido Fluid specific weight	> 0,8	
Peso Weight	~ 35 gr	