

Connettore Deutsch DTO4-2P
Connector Deutsch DTO4-2P

IP67 / IP69K

Type K0

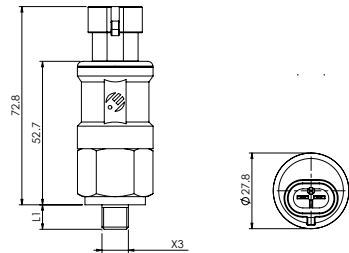

Connettore AMP Superseal 1.5 2 vie
Connector AMP Superseal 1.5 2 way

IP67 / IP69K

Type K1

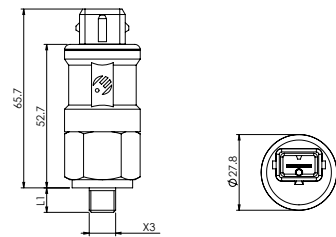

Connettore tipo AMP Junior power timer
Connector type AMP Junior power timer

IP67

Type K3

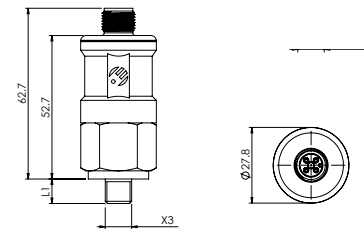

Connettore tipo M12 x 1
Connector type M12 x 1

IP67

Type K4 con pin 1-2 e 3-4 with pin 1-2 and 3-4
Type K5 con pin 1 e 4 with pin 1 and 4

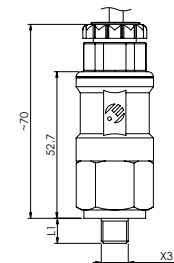

Versione cablata
Wired version

IP67 / IP69K

Type K2

Per specifiche del connettore vedi pag. 20 - 21
For connector specification see pages 20 - 21

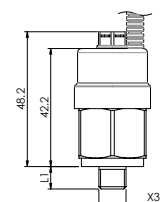

Versione cablata con sistema di sfiato
Wired version with venting system

IP67

Type W